

IMPACT RATED BOLLARDS HEIMDALL

“GUARDIAN OF THE GATE”

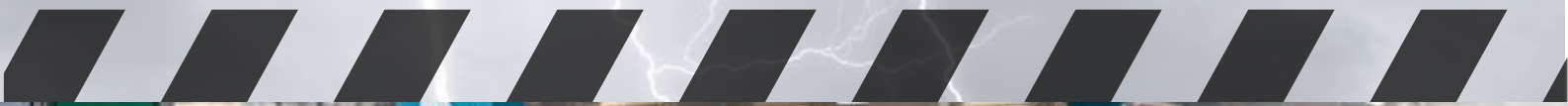

Engineered to withstand 30kN of force at 600h



INVICTA
INDUSTRIES

01. HEIMDALL - HIGH SURFACE

Short-format, impact-rated bollard designed for installations requiring minimal visual intrusion but maximum strength. Ideal for storefronts, car park barriers, or pedestrian protection.

Key Specifications

- Overall Height: 1050mm
- Fixing Type: Surface mount with base plate
- Base Plate: 315mm Ø x 22mm thick
- Anchoring: 4 x M16 Chemset anchors, 120mm embedment
- Material: 165mm x 6mm CHS
- Finish: Powder coat Safety Yellow

Rating: Engineered to withstand 30kN of force at 600h

FORM 15: Available upon request (additional fees apply)

Applications

- Retail façades
- Perimeter protection
- Warehouse and delivery zones

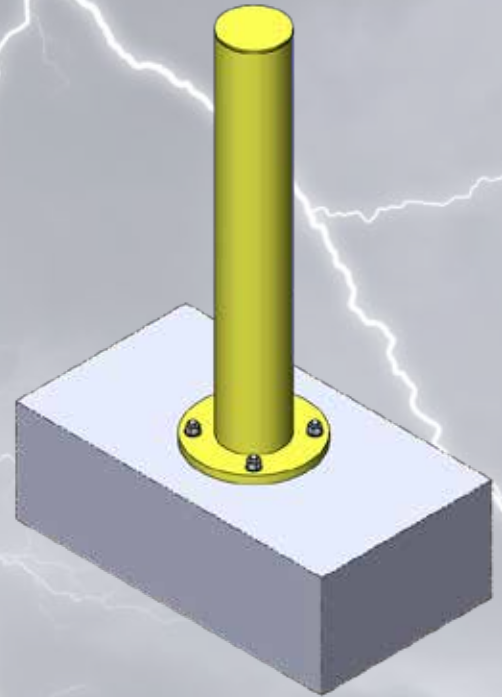

02. HEIMDALL - HIGH DISABLED SURFACE

Tall-sightline, highly visible bollard engineered for areas with disabled pedestrian or vehicle interaction. Offers enhanced deterrence and stopping capacity while maintaining ease of install via surface mounting.

Key Specifications

- Overall Height: 1400mm
- Fixing Type: Surface mount with base plate
- Base Plate: 315mm Ø x 22mm thick
- Anchoring: 4 x M16 Chemset anchors, 120mm embedment
- Material: 165mm x 6mm CHS
- Finish: Powder coat Safety Yellow

Rating: Engineered to withstand 30kN at 600h

FORM 15: Available upon request (additional fees apply)

Applications

- Disabled Car Parks
- Building setbacks
- Site demarcation lines

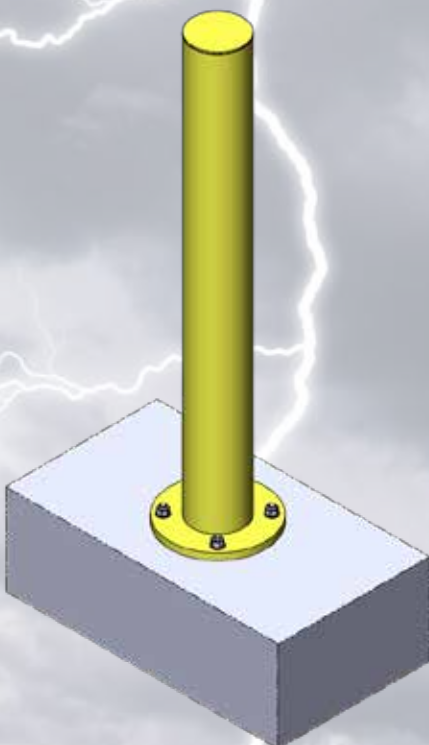

03. HEIMDALL - INGROUND CORE SET

Designed for deep-set reinforcement, the HEIMDALL-03 features a fully embedded shaft ideal for installations where ground penetration and maximum anchoring are critical.

Key Specifications

- Overall Height: 1100mm (300mm in concrete)
- Fixing Type: In-ground (core-drilled installation)
- Embedment Depth: 300mm
- Material: 165mm x 6mm CHS
- Finish: Powder coat Safety Yellow

Rating: Engineered to withstand 30kN of force at 600h

FORM 15: Available upon request (additional fees apply)

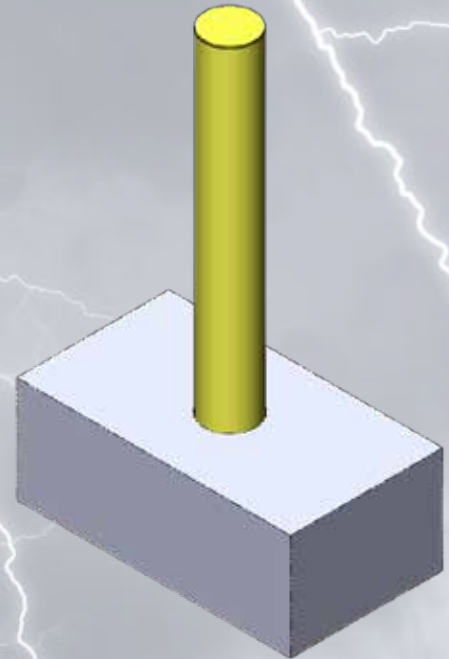

Applications

- High-risk vehicle approach areas
- Infrastructure and public utilities
- Street-facing pedestrian zones

All Inquiries :
admin@invictaindustries.com.au
0477 777 831

INVICTA
INDUSTRIES